

# Rowland Dorm Plan

Upstairs holds up to 66 (**up to 62 students plus 2 teacher rooms**)

Downstairs can hold up to 20 additional students

*numbers in parentheses indicate capacity*

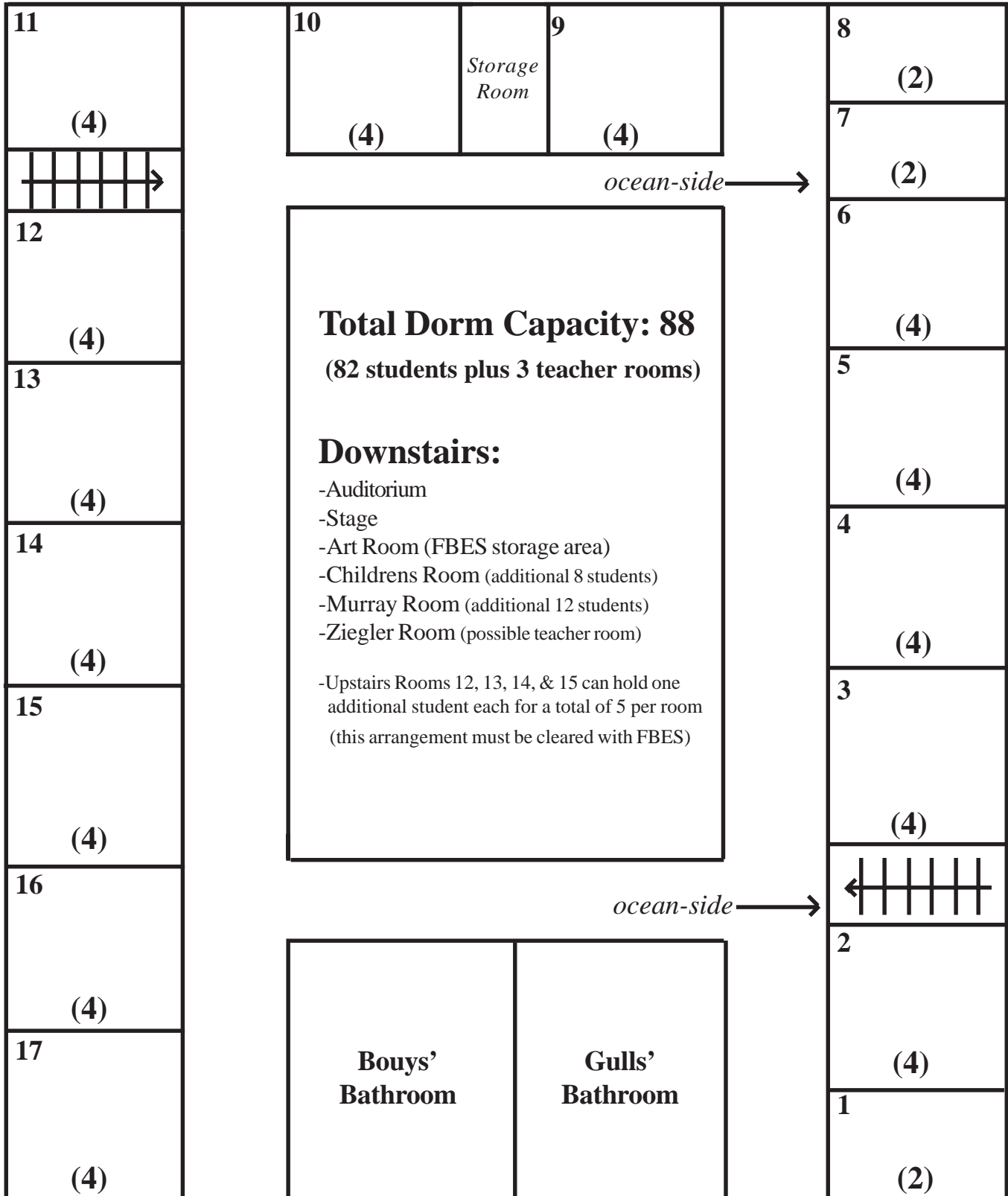

# Rowland Dorm Plan--1st floor

Upstairs holds up to 66 (**up to 62 students plus 2 teacher rooms**)

Downstairs can hold up to 20 additional students

*numbers in parentheses indicate capacity*

